

Key

- Previously agreed double yellow lines (to be installed by KCC)
- Proposed double yellow lines
- Proposed single yellow lines
Mon-Fri 11am-Noon *
- Proposed advisory cycle lanes
(1m width)
- Proposed Pay & Display ** parking bays
Mon-Fri, 8.30am-6.30pm and permit holders***
(1.8m width)
- Previously agreed 24hr bus stop clearways (to be installed by KCC)
(3m width)

Notes

* One-hour restrictions have been shown as an effective 'commuter deterrent' restriction. The time is arbitrary, but has been chosen as a quieter enforcement time as resources are more likely to be available at this time.

** Pay & Display parking is intended to remove the economic attractiveness of parking on-street compared to the off-street station car park.

It is also intended to deter those choosing to travel from Knockholt station rather than other stations (where on and off-street charges may apply) thus reducing the overall number of cars parking in the area.

Pay and display would require the installation of P&D machines, but Sevenoaks District Council is also considering the use of 'pay by phone' systems to reduce the number of machines required.

*** Residents can apply for parking permits at the same rate as other areas in the District.

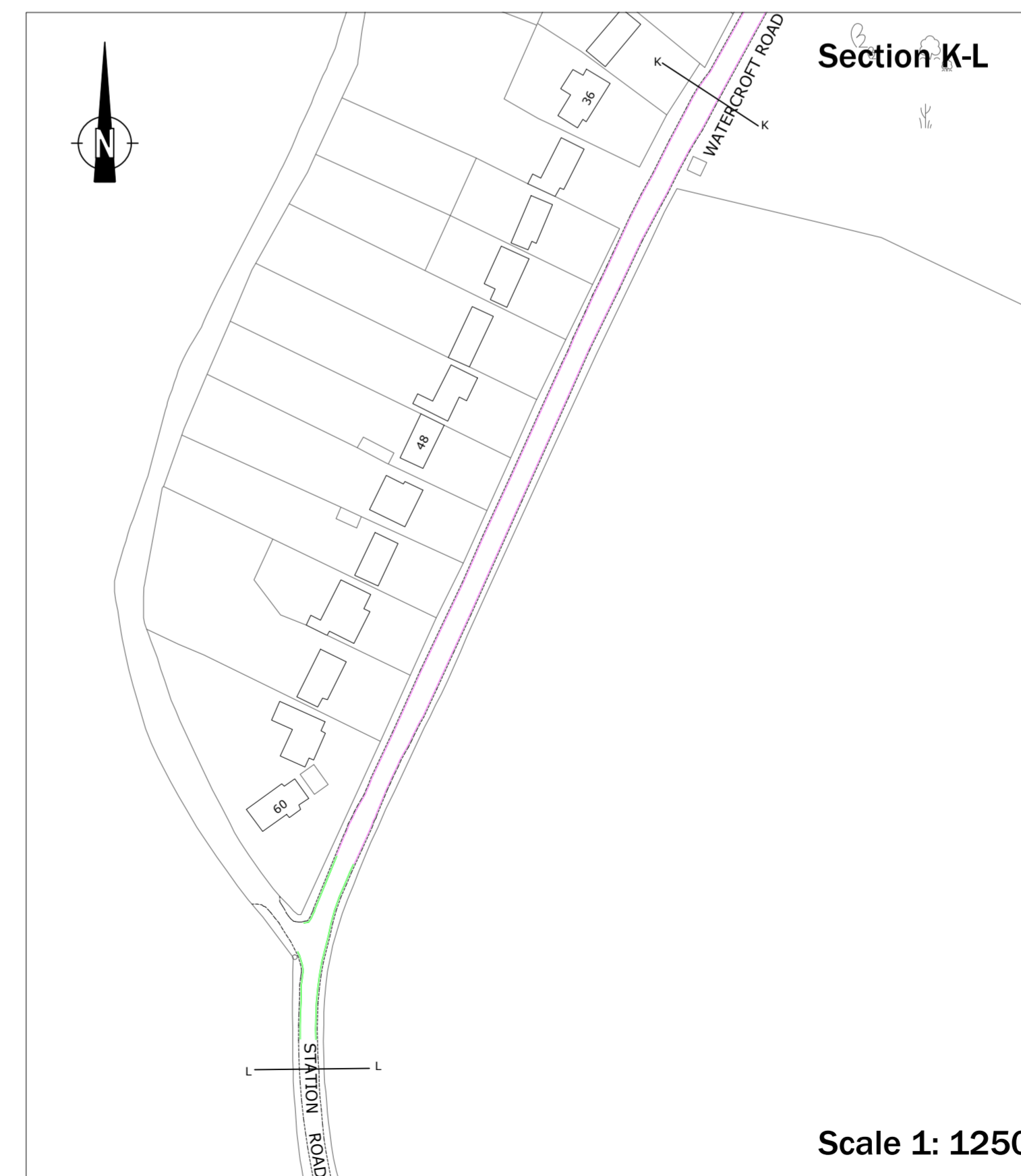
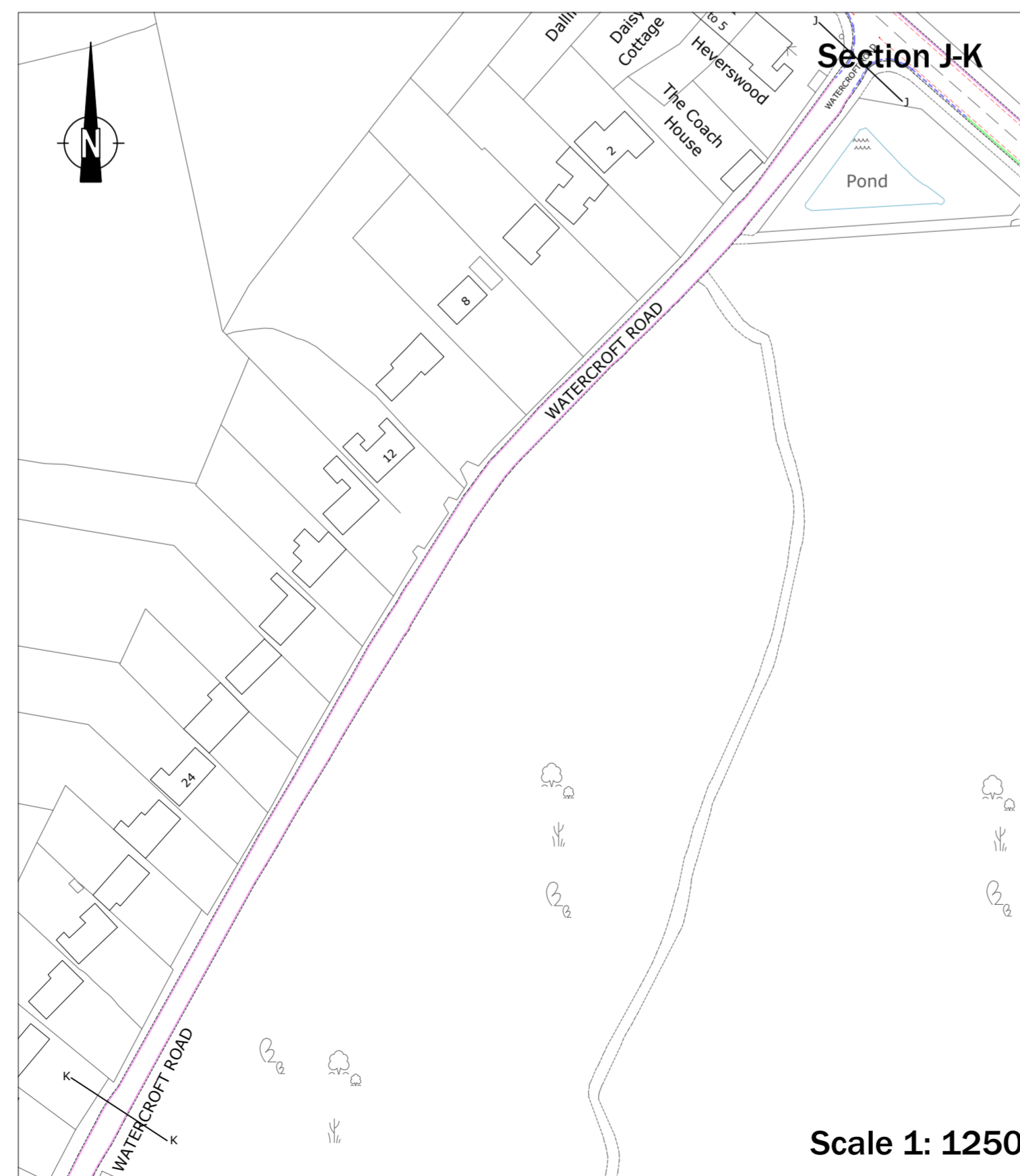
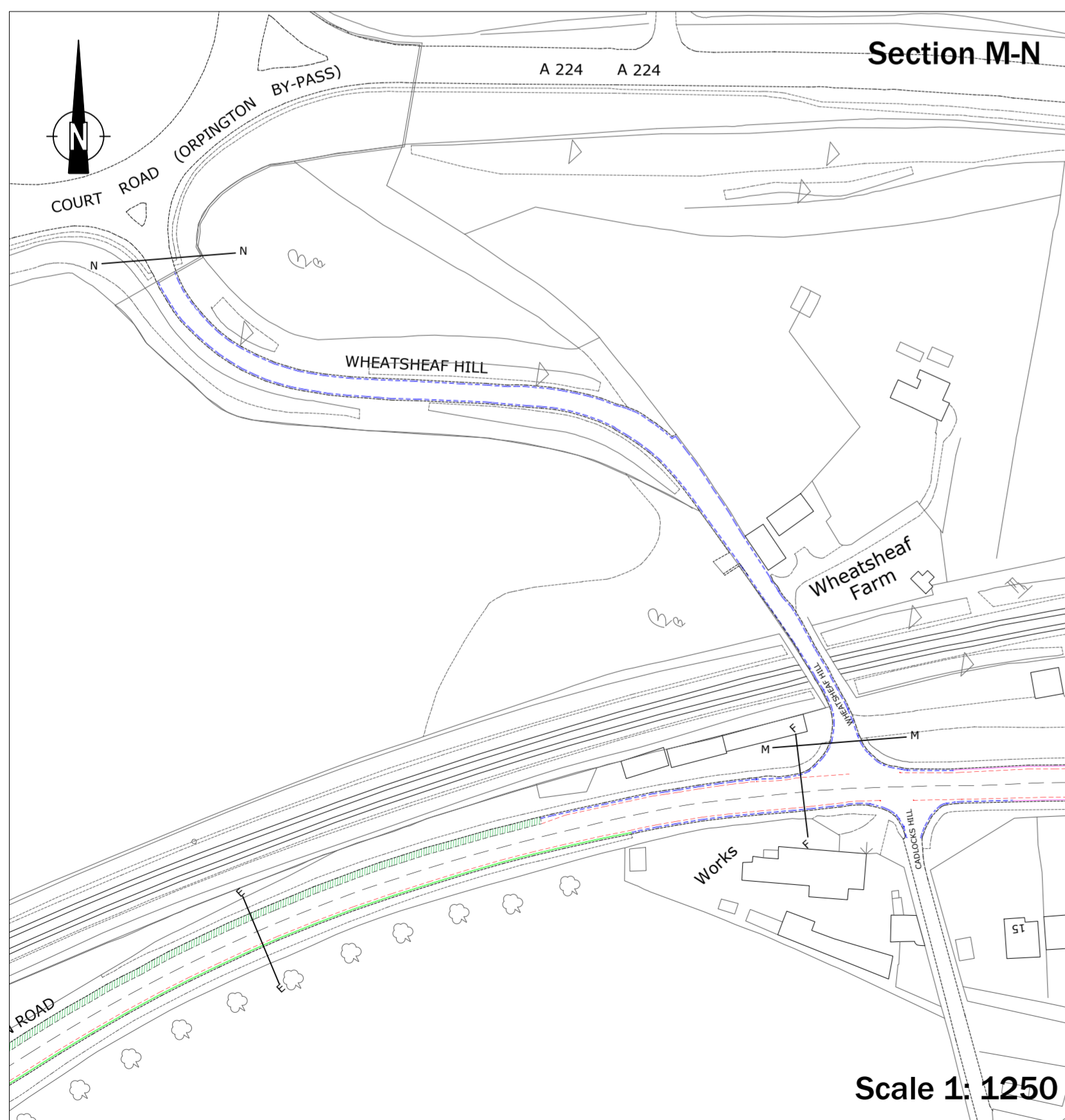

**Proposed parking restrictions - Plan 1
Knockholt Station - London Road
Halstead**

Date	Revision	Ref	Drawn
3/11	Re-consultation plan	B	ACB
4/10	Cycle lanes & bays altered	A	ACB

If you find the plans or colours confusing, please try viewing the plans on the District Council website www.sevenoaks.gov.uk
File name: Halstead - London Road Plan 1 - 240311.pdf

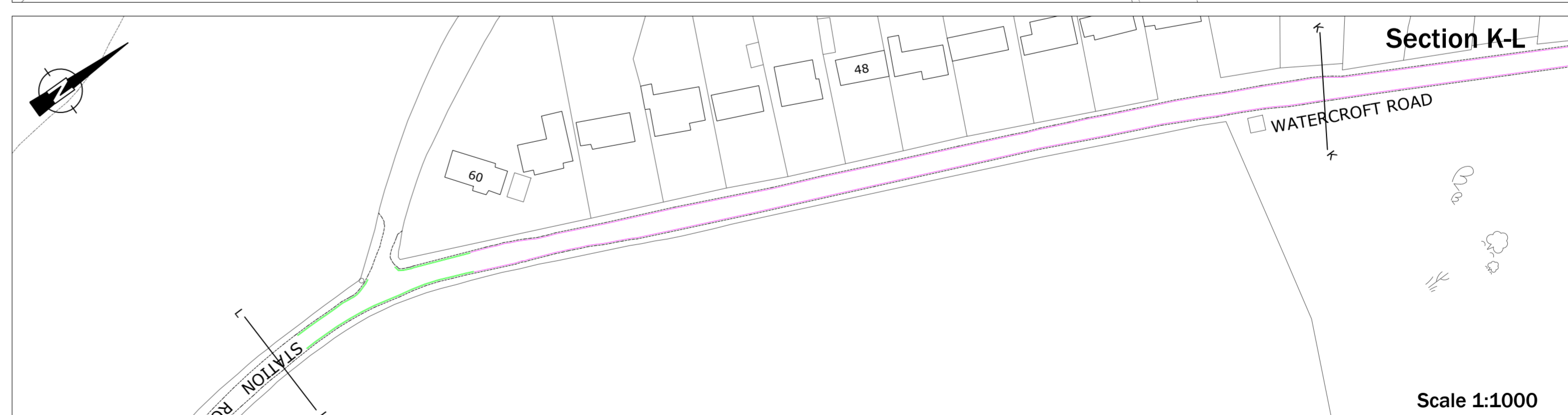
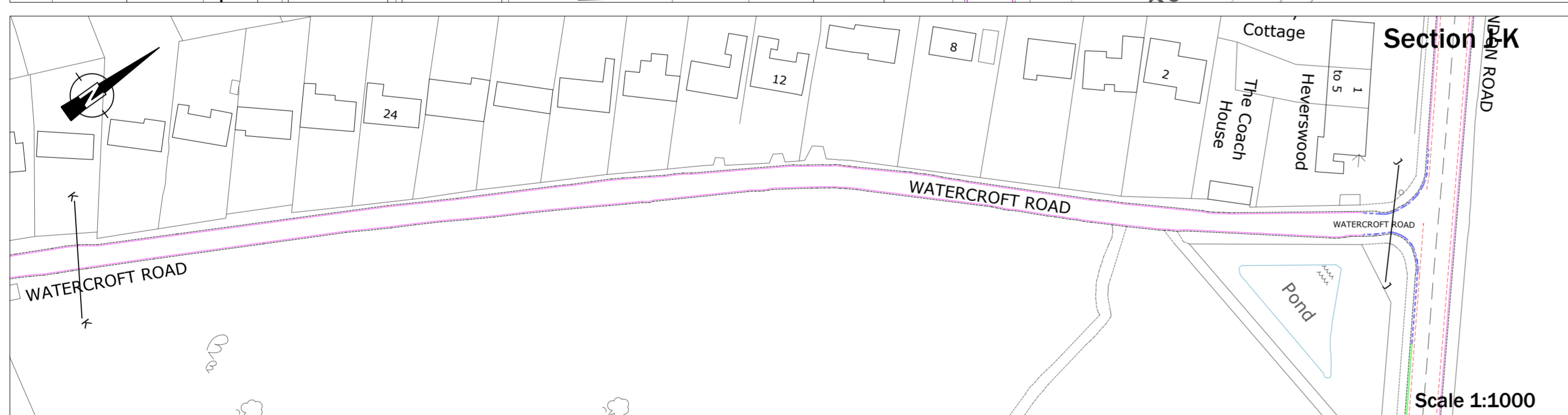
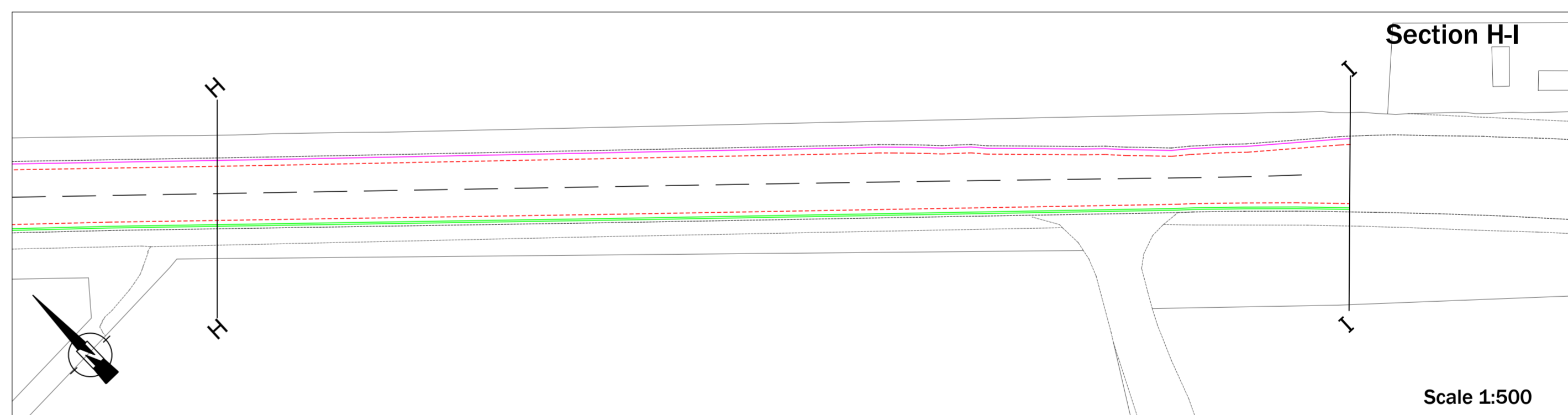
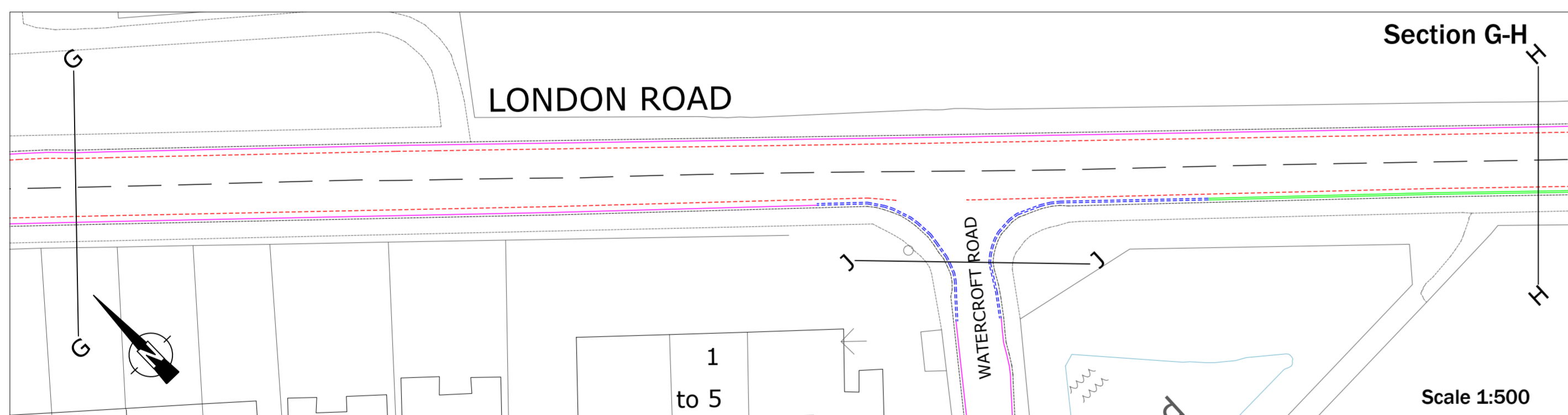
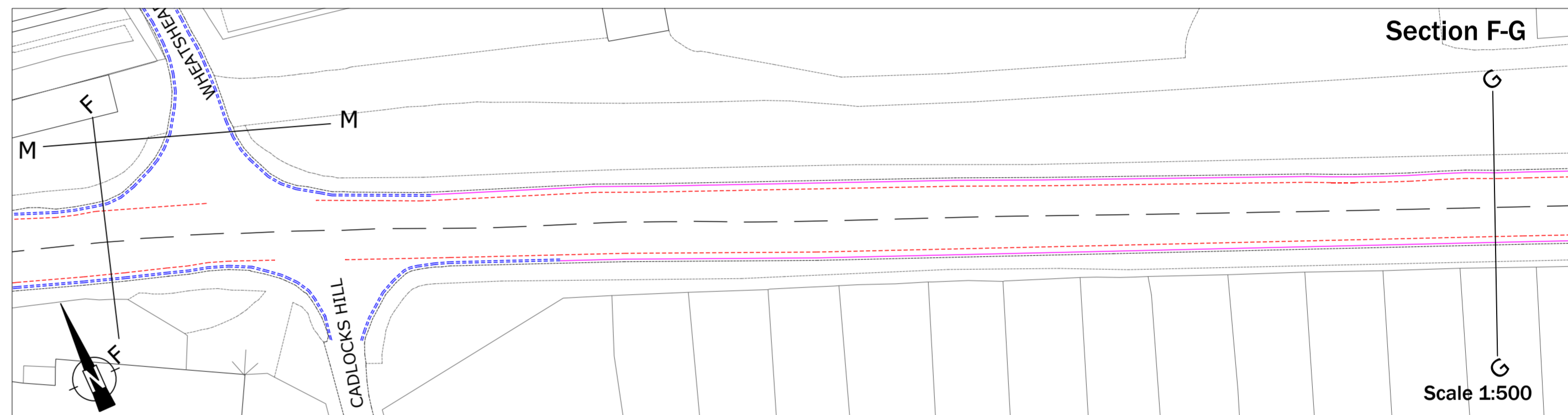
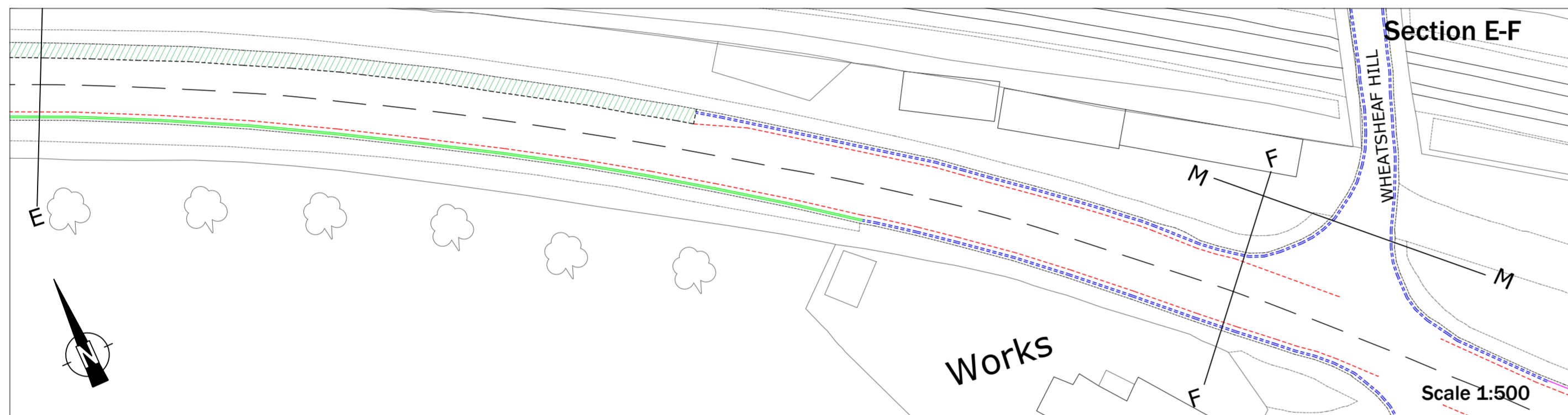
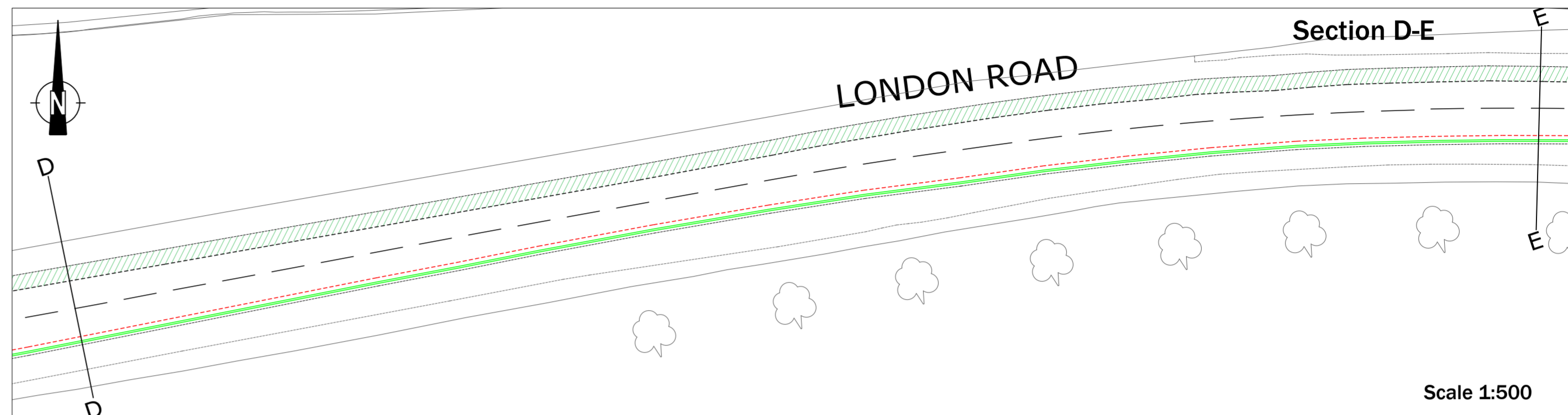
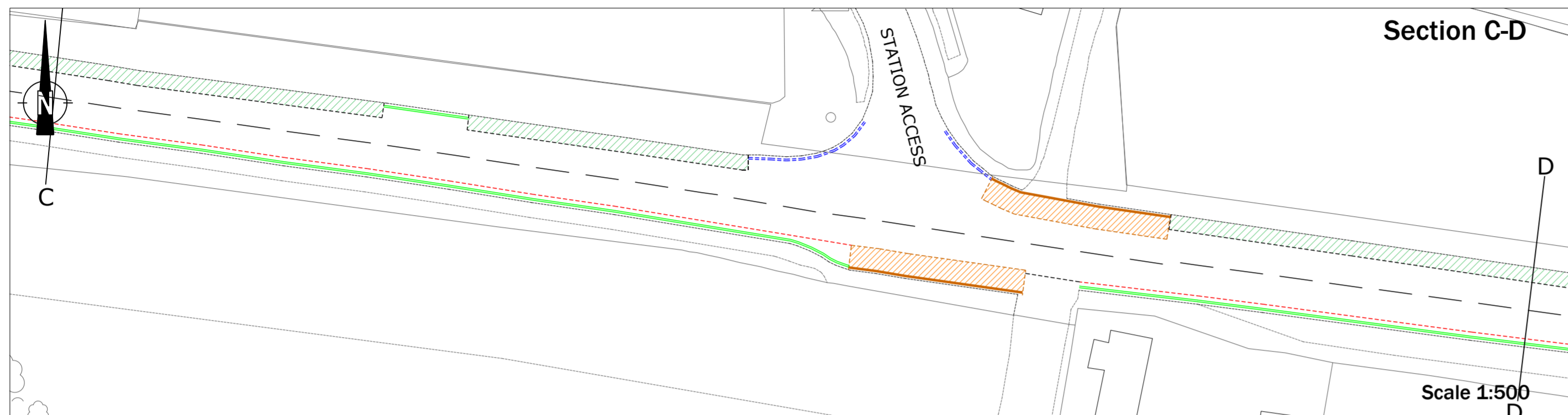
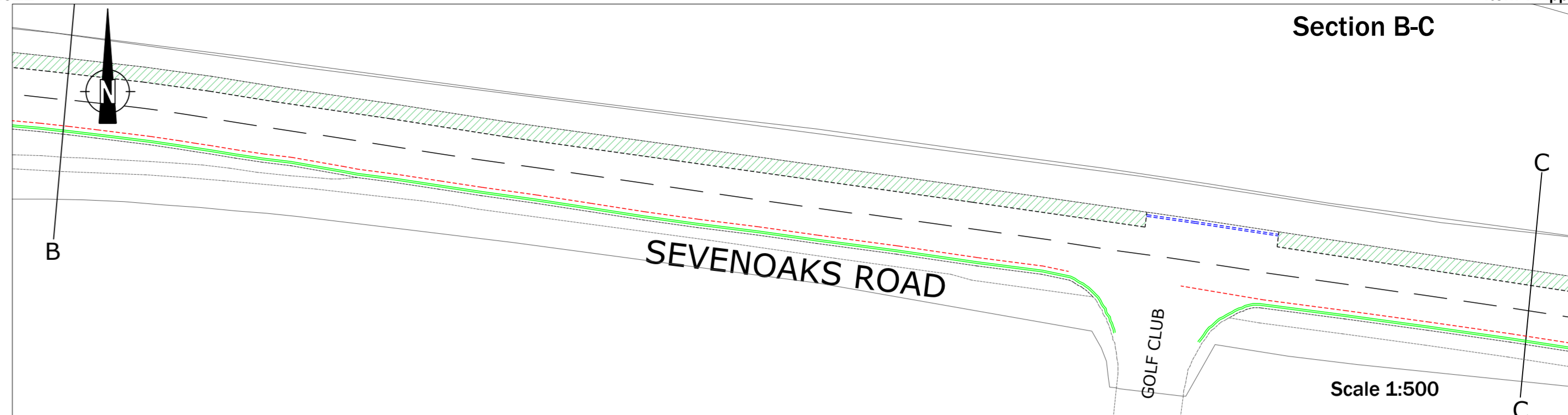
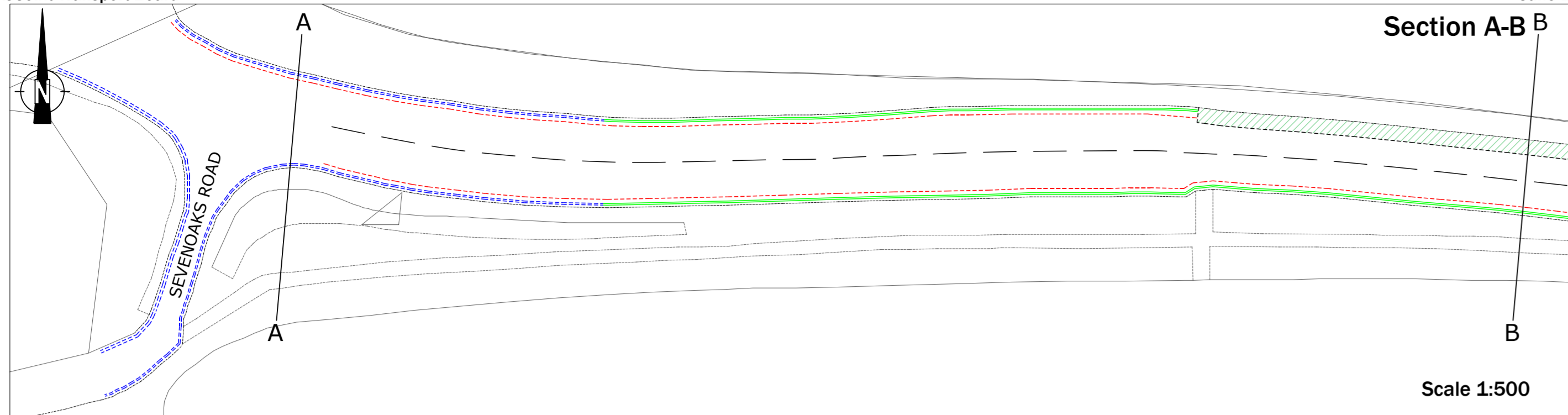

- Key**
- Previously agreed double yellow lines to be installed by KCC
 - Proposed double yellow lines
 - Proposed single yellow lines Mon- Fri, 11am - Noon *
 - Proposed advisory cycle lanes (1m width)
 - Proposed Pay & Display ** parking bays Mon-Fri, 8.30am-6.30pm and permit holders *** (1.8m width)
 - Previously agreed 24hr bus stop clearways (3m width) to be installed by KCC

Date	Revision	By	Ref	Drawn
1/10	Cycle lanes & bays altered	A	ACB	

If you find the plans or colours confusing, please try viewing the plans on the District Council website www.sevenoaks.gov.uk
 File name: Halstead - London Road Plan 2 - 240311.pdf

Proposed parking restrictions - Plan 2
Knockholt Station - London Road
Halstead